

## Double pushbuttons Non-illuminated

### Operator ...

<b>Upper button</b>		<b>Lower button</b>		<b>Catalog No.</b>	<b>Ref. Code</b>	<b>List Price</b>
Color	Text	Color	Text			
<b>with flush buttons ①</b>						
Green	No text	Red	No text	<b>MPD1-11B</b>	1SFA 611 130 R1106	<b>\$ 18.00</b>
	I	O	O	<b>MPD2-11B</b>	1SFA 611 131 R1106	<b>21.00</b>
	ON	OFF	OFF	<b>MPD3-11B</b>	1SFA 611 132 R1106	<b>21.00</b>
	START	STOP	STOP	<b>MPD4-11B</b>	1SFA 611 133 R1106	<b>21.00</b>
White	No text	Black	No text	<b>MPD5-11B</b>	1SFA 611 134 R1106	<b>18.00</b>
	I	O	O	<b>MPD6-11B</b>	1SFA 611 135 R1106	<b>21.00</b>
	ON	OFF	OFF	<b>MPD7-11B</b>	1SFA 611 136 R1106	<b>21.00</b>
	START	STOP	STOP	<b>MPD8-11B</b>	1SFA 611 137 R1106	<b>21.00</b>

### with extended lower button ①

Green	No text	Red	No text	<b>MPD12-11B</b>	1SFA 611 141 R1106	<b>18.00</b>
	I	O	O	<b>MPD13-11B</b>	1SFA 611 142 R1106	<b>21.00</b>
	ON	OFF	OFF	<b>MPD14-11B</b>	1SFA 611 143 R1106	<b>21.00</b>
	START	STOP	STOP	<b>MPD15-11B</b>	1SFA 611 144 R1106	<b>21.00</b>
White	No text	Black	No text	<b>MPD16-11B</b>	1SFA 611 145 R1106	<b>18.00</b>
	I	O	O	<b>MPD17-11B</b>	1SFA 611 146 R1106	<b>21.00</b>
	ON	OFF	OFF	<b>MPD18-11B</b>	1SFA 611 147 R1106	<b>21.00</b>
	START	STOP	STOP	<b>MPD19-11B</b>	1SFA 611 148 R1106	<b>21.00</b>

### Contact blocks, and holder

<b>Blocks</b>	<b>Catalog No.</b>	<b>Ref. Code</b>	<b>List Price</b>
2 NO with holder	<b>MCBH-20</b>	1SFA 611 605 R1102	<b>\$ 18.00</b>
2 NC with holder	<b>MCBH-02</b>	1SFA 611 605 R1120	
1 NO + 1 NC with holder	<b>MCBH-11</b>	1SFA 611 605 R1111	
1 NO without holder	<b>MCB-10</b>	1SFA 611 610 R1001	<b>8.00</b>
1 NC without holder	<b>MCB-01</b>	1SFA 611 610 R1010	<b>8.00</b>
Holder for 3 blocks	<b>MCBH-00</b>	1SFA 611 605 R1100	<b>2.00</b>

### Ordering example – Double pushbutton

Requested: A non-illuminated double pushbutton, Green/Red,  
No text, with 2 NO blocks

Ref.: 1 piece of MPD1-11B + 1 piece of MCBH-20

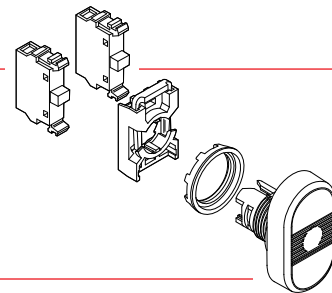

① No contact block in the center position.