

Flush and extended pushbuttons Non-illuminated

8

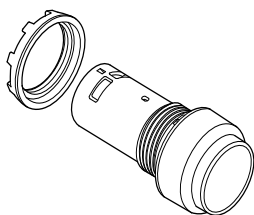
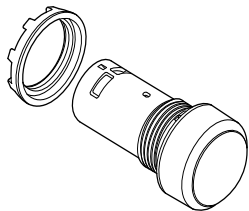

Bezel in black plastic as standard
Bezel in metal:

Replace '1' in the:
Catalog No. CP#10Δ-...
Ref. Code 1SFA619XXX R 1XXX
3 for metal bezel

Codes for button colors

	Catalog No.	Ref. Code
		‡
Red	R	1
Green	G	2
Yellow	Y	3
Blue	L	4
White	W	5
Black	B	6
Grey	U	7

Pushbutton with ...

Description	Catalog No.	Ref. Code	List Price
Flush button			
Momentary			
Contacts included:			
1 NO	CP110 -10	1SFA 619 100 R101‡	\$ 15.20
2 NO	CP110 -20	1SFA 619 100 R102‡	19.90
1 NC	CP110 -01	1SFA 619 100 R104‡	15.20
2 NC	CP110 -02	1SFA 619 100 R105‡	19.90
1 NO +1 NC	CP110 -11	1SFA 619 100 R107‡	19.90
Maintained			
Contacts included:			
1 NO	CP210 -10	1SFA 619 101 R101‡	19.90
2 NO	CP210 -20	1SFA 619 101 R102‡	22.50
1 NC	CP210 -01	1SFA 619 101 R104‡	19.90
2 NC	CP210 -02	1SFA 619 101 R105‡	22.50
1 NO +1 NC	CP210 -11	1SFA 619 101 R107‡	22.50
Extended button			
Momentary			
Contacts included:			
1 NO	CP310 -10	1SFA 619 102 R101‡	15.20
2 NO	CP310 -20	1SFA 619 102 R102‡	19.90
1 NC	CP310 -01	1SFA 619 102 R104‡	15.20
2 NC	CP310 -02	1SFA 619 102 R105‡	19.90
1 NO +1 NC	CP310 -11	1SFA 619 102 R107‡	19.90
Maintained			
Contacts included:			
1 NO	CP410 -10	1SFA 619 103 R101‡	19.90
2 NO	CP410 -20	1SFA 619 103 R102‡	22.50
1 NC	CP410 -01	1SFA 619 103 R104‡	19.90
2 NC	CP410 -02	1SFA 619 103 R105‡	22.50
1 NO +1 NC	CP410 -11	1SFA 619 103 R107‡	22.50