

Flush and extended pushbuttons

Non-illuminated and illuminated

Momentary and maintained

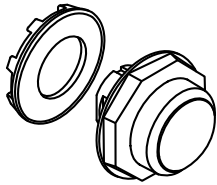

Flush

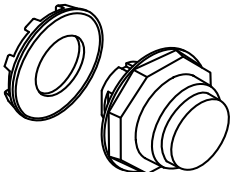

Extended

Δ Non-illuminated
button color

R Red
G Green
Y Yellow
L Blue
W White
B Black
C Clear

‡ Illuminated
button color

R Red
G Green
Y Yellow
L Blue
W White
C Clear

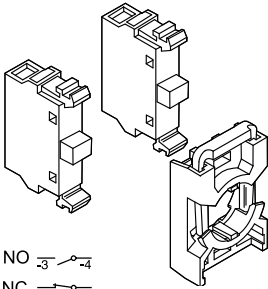

NO $\overline{1}$ \rightarrow $\overline{4}$
NC $\overline{1}$ \rightarrow $\overline{2}$

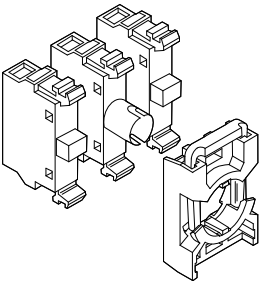

Non-illuminated

Description	Catalog number	List price
Black plastic bezel		
Flush, momentary	G1MP1-10Δ	\$ 14.10
Flush, maintained	G1MP2-10Δ	25.30
Extended, momentary	G1MP3-10Δ	14.10
Extended, maintained	G1MP4-10Δ	25.30
Chrome bezel		
Flush, momentary	G2MP1-30Δ	16.10
Flush, maintained	G2MP2-30Δ	27.30
Extended, momentary	G2MP3-30Δ	16.10
Extended, maintained	G2MP4-30Δ	27.30

Illuminated^①

Description	Catalog number	List price
Black plastic bezel		
Flush, momentary	G1MP1-11‡	\$ 14.10
Flush, maintained	G1MP2-11‡	25.30
Extended, momentary	G1MP3-11‡	14.10
Extended, maintained	G1MP4-11‡	25.30
Chrome bezel		
Flush, momentary	G2MP1-31‡	16.10
Flush, maintained	G2MP2-31‡	27.30
Extended, momentary	G2MP3-31‡	16.10
Extended, maintained	G2MP4-31‡	27.30

Contact blocks, lamp block and holder^②

Blocks	Catalog number	Ref. code	List price
1 NO with holder	MCBH-10	1SFA 611 605 R1101	\$ 10.00
1 NC with holder	MCBH-01	1SFA 611 605 R1110	10.00
2 NO with holder	MCBH-20	1SFA 611 605 R1102	18.00
2 NC with holder	MCBH-02	1SFA 611 605 R1120	18.00
1 NO + 1 NC with holder	MCBH-11	1SFA 611 605 R1111	18.00
1 NO + 1 LB with holder	MCBH-101	1SFA 611 605 R1201	27.50
1 NC + 1 LB with holder	MCBH-011	1SFA 611 605 R1210	27.50
2 NO + 1 LB with holder ^①	MCBH-201	1SFA 611 605 R1202	35.50
2 NC + 1 LB with holder	MCBH-021	1SFA 611 605 R1220	35.50
1 NO + 1 NC + 1 LB with holder	MCBH-111	1SFA 611 605 R1211	35.50
1 NO without holder	MCB-10	1SFA 611 610 R1001	8.00
1 NC without holder	MCB-01	1SFA 611 610 R1010	8.00
Lamp block for 2 W, max 230 V AC/DC bulb or LED	MLB-1	1SFA 611 620 R1001	17.50
Holder for 3 blocks	MCBH-00	1SFA 611 605 R1100	2.00

Ordering example

Requested: A modular pushbutton, momentary,
with red flush button and one NO contact.

Ref.: 1 piece of G1MP1- 40R +1 piece of MCBH-10

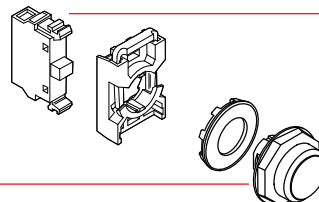

^① No contact block in the center position.

^② Lamp block MLB-1. Bulb not included. Other lamp block see Accessories, bulb max 1.2 W.